

# PAC-W 2650 SH

**EN**

**INSTRUCTIONS**  
MONOBLOC AIR  
CONDITIONER WITHOUT  
EXTERNAL UNIT



## Table of contents

Information on the use of these instructions .....	2
Safety .....	2
Information about the device .....	5
Transport and storage .....	6
Assembly and start-up .....	7
Operation .....	10
Errors and faults .....	13
Maintenance .....	15
Technical annex.....	17
Disposal .....	21
Simplified EU Declaration of Conformity .....	21

## Information on the use of these instructions

### Symbols



#### **Danger**

This symbol indicates dangers to the life and health of persons due to extremely flammable gas.



#### **Warning of electrical voltage**

This symbol indicates dangers to the life and health of persons due to electrical voltage.



#### **Warning of hot surface**

This symbol indicates dangers to the life and health of persons due to hot surface.



#### **Warning**

This signal word indicates a hazard with an average risk level which, if not avoided, can result in serious injury or death.



#### **Caution**

This signal word indicates a hazard with a low risk level which, if not avoided, can result in minor or moderate injury.

#### **Notice**

This signal word indicates important information (e.g. material damage), but does not indicate hazards.



#### **Info**

Information marked with this symbol helps you to carry out your tasks quickly and safely.



### Follow the manual

Information marked with this symbol indicates that the instructions must be observed.

You can download the current version of the instructions and the EU declaration of conformity via the following link:

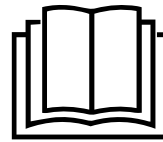

PAC-W 2650 SH



<https://hub.trotec.com/?id=46475>

## Safety

**Read this manual carefully before starting or using the device. Always store the manual in the immediate vicinity of the device or its site of use.**



### Warning

**Read all safety warnings and all instructions.**

Failure to follow the warnings and instructions may result in electric shock, fire and/or serious injury.

**Save all warnings and instructions for future reference.**

This appliance can be used by children aged from 8 years and above and persons with reduced physical, sensory or mental capabilities or lack of experience and knowledge if they have been given supervision or instruction concerning use of the appliance in a safe way and understand the hazards involved.

Children shall not play with the appliance. Cleaning and user maintenance shall not be done by children without supervision.

- Do not use the device in potentially explosive rooms or areas and do not install it there.
- Do not use the device in an aggressive atmosphere.
- Let the device dry out after a wet clean. Do not operate it when wet.
- Do not use the device with wet or damp hands.
- Do not expose the device to directly squirting water.
- Never insert any objects or limbs into the device.
- Do not cover the device during operation.
- Do not sit on the device.
- This appliance is not a toy. Keep away from children and animals.
- Check accessories and connection parts for possible damage prior to every use of the device. Do not use any defective devices or device parts.

- Ensure that all electric cables outside of the device are protected from damage (e.g. caused by animals). Never use the device if electric cables or the power connection are damaged!
  - The mains connection must correspond to the specifications in the Technical annex.
  - Insert the mains plug into a properly fused mains socket.
  - Observe the technical data when selecting extensions to the power cable. Completely unroll the extension cable. Avoid electrical overload.
  - Before carrying out maintenance, care or repair work on the device, remove the mains plug from the mains socket. Hold onto the mains plug while doing so.
  - Switch the device off and disconnect the power cable from the mains socket when the device is not in use.
  - Do not under any circumstances use the device if you detect damages on the mains plug or power cable. If the supply cord is damaged, it must be replaced by a special cord or assembly available from the manufacturer or its service agent.  
Defective power cables pose a serious health risk!
  - When positioning the device, observe the minimum distances from walls and other objects as well as the storage and operating conditions specified in the Technical annex.
  - Make sure that the air inlet and outlet are not obstructed.
  - Do not remove any safety signs, stickers or labels from the device. Keep all safety signs, stickers and labels in legible condition.
  - Make sure that the suction side is kept free of dirt and loose objects.
  - Only transport the device in an upright position with an emptied condensation tray or drain hose.
  - Discharge the collected condensate before transport and storage. Do not drink it. Health hazard!
  - For complex installations, contact a specialist company for cooling and air-conditioning or Trotec.
  - Use batteries of type AAA.
  - Do not insert rechargeable batteries into the remote control.
  - Never charge batteries that cannot be recharged.
  - Different types of batteries and new and used batteries must not be used together.
  - Insert the batteries into the battery compartment according to the correct polarity.
  - Remove discharged batteries. Batteries contain materials hazardous to the environment. Dispose of the batteries according to the national regulations.
  - Remove the batteries from the remote control if you will not be using the device for a longer period of time.
  - Never short-circuit the terminals of batteries!
  - Do not swallow batteries! If a battery is swallowed, it can cause severe internal burns within 2 hours! These burns can lead to death!
  - If you think batteries might have been swallowed or otherwise entered the body, seek medical attention immediately!
  - Keep new and used batteries and an open battery compartment away from children.
  - If the battery compartment does not close securely, stop using the product via the remote control.
  - Only install the device in compliance with the national installation regulations.
  - Only install, operate and store the device in a room measuring more than 15 m<sup>2</sup>.
  - Store the device in a way that no mechanical damage can occur.
  - The entire refrigerant circuit is a maintenance-free, hermetically sealed system and may only be maintained or repaired by specialist companies for cooling and air-conditioning or by the manufacturer.
- Safety instructions for servicing the refrigerant circuit:**
- Every person working with or at the refrigerant circuit must be able to provide a certificate of qualification issued by a body accredited by the industry, demonstrating their competence in the safe use of refrigerants based on a procedure well-known in the industry.
  - Service work may only be carried out in accordance with the manufacturer's specifications. If maintenance and repair work require the support of additional persons, the person trained in handling flammable refrigerants shall continuously supervise the work carried out.
  - Do not use any means other than those recommended by the manufacturer for accelerating the defrosting process.
  - Do not drill into or burn.
  - Please note that the refrigerant is odourless.
  - Observe the national regulations for gas installations.
  - Observe the maximum refrigerant capacity in the technical data.
  - R290 is a refrigerant that complies with European environmental regulations. No part of the cooling circuit may be perforated.

## Intended use

Only use the device for cooling, ventilating, dehumidifying and heating indoor air whilst adhering to the technical data.

Any use other than the intended use is regarded as misuse.

## Reasonably foreseeable misuse

- Do not place any objects, e.g. clothing, on the device.
- Do not use the device out of doors.
- Do not make any unauthorised modifications, alterations or structural changes to the device.
- Do not use the device in the immediate vicinity of swimming pools, bathtubs and showers.

## Personnel qualification

People who use this device must:

- be aware of the dangers that occur when working with electric devices in damp areas.
- have read and understood the instructions, especially the Safety chapter.

Maintenance tasks which require the housing to be opened must only be carried out by specialist companies for cooling and air-conditioning or by the manufacturer.

## Safety signs and labels on the device

### Notice

Do not remove any safety signs, stickers or labels from the device. Keep all safety signs, stickers and labels in legible condition.





The following safety signs and labels are attached to the device:

**WARNING • WARNUNG • ATTENTION**

**DE** Das Gerät muss in einem Raum mit einer Grundfläche größer als 15 m<sup>2</sup> aufgestellt, betrieben und gelagert werden.

**EN** Appliance shall be installed, operated and stored in a room with floor area larger than 15 m<sup>2</sup>.

**FR** L'appareil doit être installé, utilisé et entreposé dans une pièce avec une surface supérieure à 15 m<sup>2</sup>.



### Follow the manual

This symbol indicates that the instructions must be observed.



### Follow the repair manual

Disposal, maintenance and repair work of the refrigerant circuit may only be carried out in accordance with the manufacturer's specifications and by persons having a certificate of qualification. A corresponding repair manual is available from the manufacturer upon request.

## !!! ACHTUNG !!!

1. Vor Inbetriebnahme MIND. 12 STUNDEN aufrecht und still stehen lassen! Das schützt den Kompressor, verlängert die Lebensdauer erheblich und verhindert so einen Verlust der Kühlleistung.
2. Das Klimagerät muss immer BESONDERS VORSICHTIG auf den Boden gestellt werden! Ansonsten können Mikrorisse in der Bodenplatte und der Kondensatwanne entstehen, was dazu führt, dass Kondenswasser auf den Boden tropft.

Für Schäden, die durch unsachgemäßen Gebrauch entstehen, übernehmen wir KEINE GEWÄHRLEISTUNG!

## !!! WARNING !!!

1. Before operation, stand upright and rest for MIN 12 HOURS! This protects the compressor, greatly extending its life and preventing loss of cooling performance.
2. The air conditioner must always be placed on the floor with CAUTION! Otherwise, microcracks may form in the bottom plate and the condensate pan, causing condensation to drip onto the floor.

For damages caused by improper use, WARRANTY WILL BE NULL AND VOID!

## !!! ATTENTION !!!

1. Avant la mise en service, laissez immobile en position verticale PENDANT AU MOINS 12 HEURES ! Cela protège le compresseur, prolonge sensiblement la durée de vie et évite ainsi une diminution des performances de refroidissement.
2. Le climatiseur doit toujours être posé sur le sol AVEC LES PLUS GRANDES PRÉCAUTIONS ! Sinon, des micro-fissures risquent de se former dans le socle ou le bac de récupération de l'eau de condensation, ce qui entraînerait que cette dernière coule sur le sol.

Toute utilisation incorrecte ou non conforme entraîne L'EXTINCTION DE LA GARANTIE !

## Residual risks



### Danger

#### Natural refrigerant propane (R290)!

H220 – Extremely flammable gas.

H280 – Contains gas under pressure; may explode if heated.

P210 – Keep away from heat, sparks, open flames and other ignition sources. No smoking.

P377 – Leaking gas fire: Do not extinguish, unless leak can be stopped safely.

P410+P403 – Protect from sunlight. Store in a well-ventilated place.



### Warning of electrical voltage

Work on the electrical components must only be carried out by an authorised specialist company!

**Warning of electrical voltage**

Before any work on the device, remove the mains plug from the mains socket!

Do not touch the mains plug with wet or damp hands. Hold onto the mains plug while pulling the power cable out of the mains socket.

**Warning of electrical voltage**

Risk of electric shock!

The device is not protected against water.

There is a risk of electric shock!

Never use the device in areas where dripping, spraying or running water can enter the device! Never immerse the device in water!

**Warning of hot surface**

In heating mode, the ventilation flap at the air outlet may become very hot and cause burns. Do not touch the ventilation flap during and after heating operation. Risk of burns.

**Warning**

Dangers can occur at the device when it is used by untrained people in an unprofessional or improper way! Observe the personnel qualifications!

**Warning**

A falling device can cause injuries! Always transport and assemble the device with the help of other persons. Never stand below the device when it is suspended. Ensure adequate stability of the device's wall fixing.

**Warning**

The device is not a toy and does not belong in the hands of children.

**Warning**

Risk of suffocation!

Do not leave the packaging lying around. Children may use it as a dangerous toy.

**Notice**

Do not operate the device without an inserted air filter! Without the air filter, the inside of the device will be heavily contaminated. This could reduce the performance and result in damage to the device.

**Behaviour in the event of an emergency**

1. Switch the device off.
2. Disconnect the device from the mains by removing the mains plug from the socket. When doing so, be sure to hold the plug, not the cable.
3. Do not reconnect a defective device to the mains.

**Information about the device****Device description**

The device serves the purpose of cooling the room air. In addition, the device dehumidifies the air and thus creates a pleasant room climate. Additionally, the device can be used as heater.

The device is installed on a wall from which a connection to the outside is established. The device does not require an external unit.

The device cools the room air by withdrawing warmth. The absorbed warmth is emitted to the outside via the exhaust air pipe; cooled air is fed to the installation site by means of a fan.

Accumulating condensate drips from the evaporator onto the hot condenser, there it evaporates and then is transported to the outside via the condensation hose.

In *ventilation* mode the device provides the opportunity of air circulation without cooling effect.

In *dehumidification* mode moisture is withdrawn from the air.

In *heating* mode the room air is warmed up.

The device operates fully automatically and features a variety of further options. The device can, for instance, be switched on or off automatically with time delay via the timer function.

The inverter technology of the device allows it to remain in permanent operation and to keep the room temperature constant without fluctuations. To do so, the device constantly monitors the temperature and steplessly adjusts the speed.

Operation of the device is possible either via the control panel at the device or via the supplied infrared remote control.

In addition, the device comes with a WiFi app control with additional functions.

## Device depiction

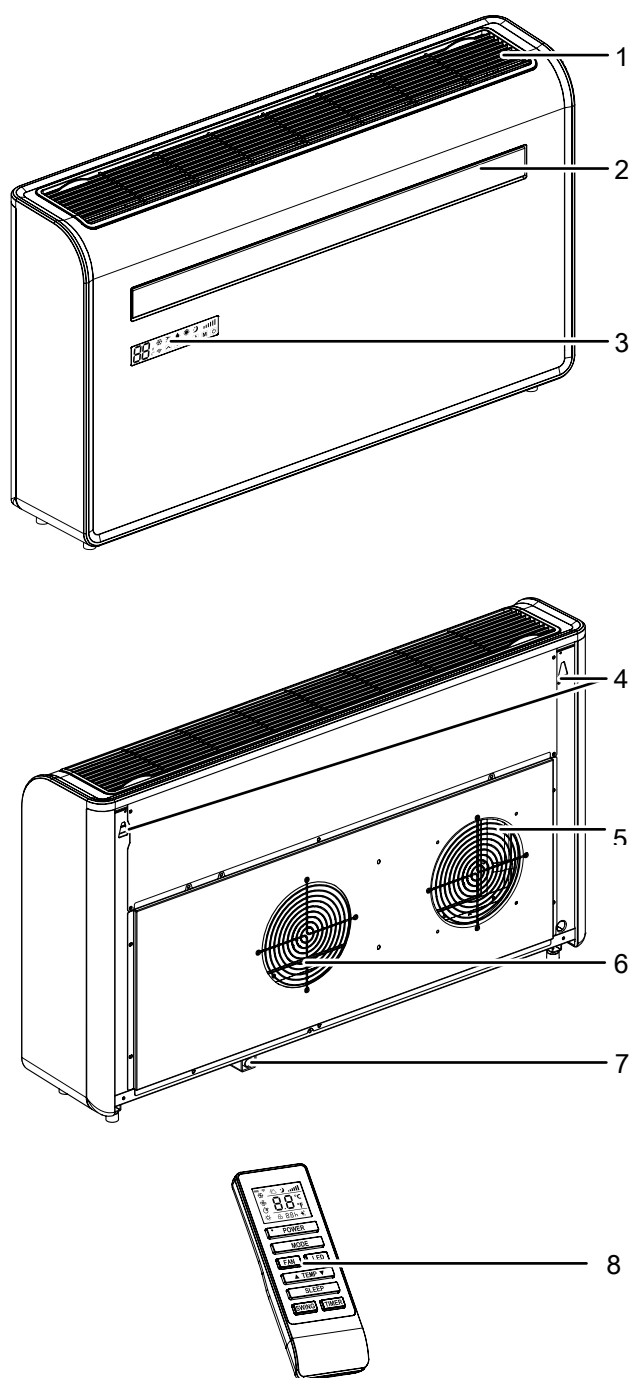

No.	Designation
1	Air inlet (with air filter)
2	Air outlet with adjustable ventilation flap
3	Control panel
4	Wall mountings
5	Air outlet
6	Air inlet
7	Condensation drain
8	Remote control

## Transport and storage

### Notice

If you store or transport the device improperly, the device may be damaged.

Note the information regarding transport and storage of the device.

### Transport

Please note that additional transport regulations might apply to devices containing flammable refrigerants. The equipment's arrangement and the maximum number of components to be transported together can be gathered from the applicable transport regulations.

**Before** transporting the device, observe the following:

- Switch the device off.
- Disconnect the device from the mains by removing the mains plug from the socket. When doing so, be sure to hold the plug, not the cable.
- Drain the remaining condensate from the device.
- Disassemble the device in reverse order of the assembly.
- Do not use the power cable to drag the device.

**After** transporting the device, proceed as follows:

- Set up the device in an upright position after transport.
- Mount the device on the wall as described in the Assembly chapter.
- Leave the device to rest for at least 12 hours, so the refrigerant can accumulate within the compressor. Wait 12 hours before switching the device back on! Acting contrary might lead to compressor damage and a malfunctioning device.

### Storage

**Before** storing the device, observe the following:

- Drain the remaining condensate from the device.
- Disconnect the device from the mains by removing the mains plug from the socket. When doing so, be sure to hold the plug, not the cable.
- Disassemble the device in reverse order of the assembly.

When the device is not being used, observe the following storage conditions:

- Only store the device in a room measuring more than 15 m<sup>2</sup>.
- Only position the device in rooms where there is no source of ignition (e.g. open flames, an active gas appliance or an electric heater).
- Store the device in a dry location and protected from frost and heat.
- Store the device in an upright position where it is protected from dust and direct sunlight.



- If required, use a cover to protect the device from invasive dust.
- Place no further devices or objects on top of the device to prevent it from being damaged.
- Remove the batteries from the remote control.

## Assembly and start-up

### Scope of delivery

- 1 x Device
- 2 x Hose adapter (interior)
- 2 x Hose adapter (exterior)
- 4 x Connecting chain
- 1 x Wall template
- 2 x Locking screw
- 1 x Suspension rail
- 1 x Mounting bracket
- 1 x Set with screws, wall plugs and washers
- 1 x Remote control (without batteries)
- 1 x Manual

### Unpacking the device

1. Open the cardboard box and take the device out.
2. Completely remove the packaging.
3. Fully unwind the power cable. Make sure that the power cable is not damaged and that you do not damage it during unwinding.

## Start-up



### Info

#### Recommendation for the installation

In order to provide a professional installation and failure-free operation, Trotec GmbH recommends that the installation is carried out by a specialist installer.



### Info

Prior to installing the device, carry out a calculation of the required power. The more accurate the calculation, the more efficient is the operation of the device.

Observe the applicable regulations when performing calculations.

Observe the following instructions:

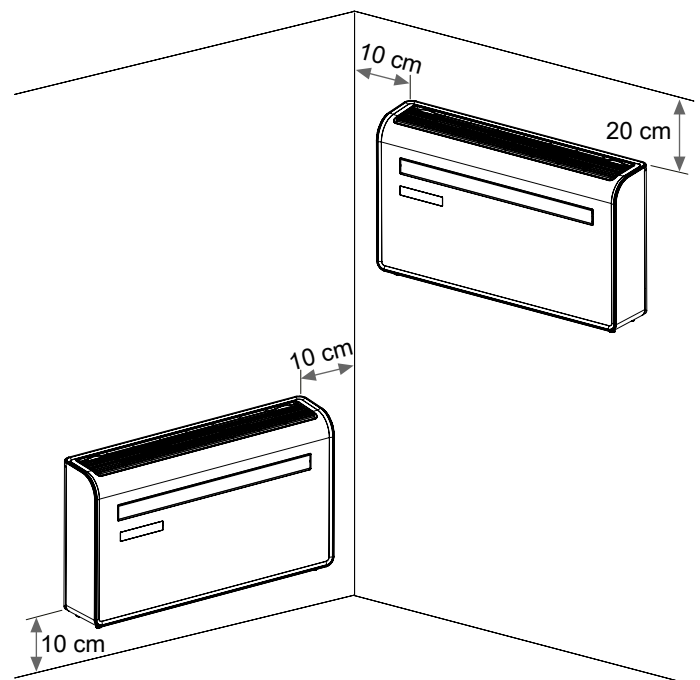

- Before restarting the device, check the condition of the power cable. If there are doubts as to the sound condition, contact the customer service.
- Only install the device in rooms where potentially leaking refrigerant cannot accumulate.
- Do not create tripping hazards when laying the power cable or other electrical cables. Use cable bridges.
- Make sure that extension cables are completely unrolled.
- Keep air inlets and outlets as well as the condensation hose connection free.
- Make sure that no curtains or other objects interfere with the air flow.

## Inserting batteries into the remote control



### Warning of electrical voltage

Do not touch the battery compartment with wet or damp hands.

### Notice

Do not use rechargeable batteries!

Please proceed as follows to insert or exchange the batteries:

1. Press the upper part on the back of the remote control and pull the battery cover off the remote control.
2. Insert two batteries into the battery compartment.  
⇒ Observe the correct polarity.
3. Slide the battery cover back onto the remote control.

## Inserting the air filter

### Notice

Do not operate the device without an inserted air filter! Without the air filter, the inside of the device will be heavily contaminated. This could reduce the performance and result in damage to the device.

- Make sure that the air filter is installed before switching the device on.

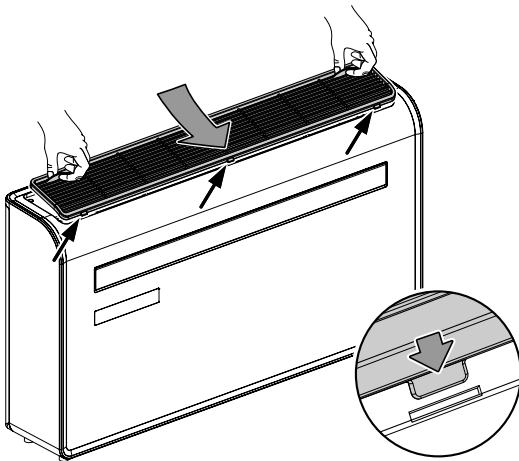

## Assembly

Always utilize the help of another person to assemble the device. Do not try to assemble the device without the help of another person. To lift the device, use a forklift or an elevating truck as appropriate.



### Warning of electrical voltage

Risk of electric shock!

The device is not protected against water.

There is a risk of electric shock!

Never use the device in areas where dripping, spraying or running water can enter the device! Never immerse the device in water!



### Warning

The wall on which the device is to be mounted must be stable, robust and suitable for supporting the weight of the device.

Before installation, check the wall area where you want to drill for steel beams, gas lines, water pipes, wastewater pipes, electrical lines or similar.



### Warning

Draining condensate water must not cause any damage.



### Info

Install the device on a wall facing the outside of the building.

The following tools are required for assembly:

- Spirit level
- Drill
- Tape measure
- Cutter knife
- Pen
- 8 mm masonry drill bit
- 20 mm masonry drill bit
- 180 mm core drill bit

Assemble the device as follows.

Select screw and wall plug sizes suitable for the weight of the device (see technical data) and the structure of the wall.

1. Align the supplied wall template on the wall and stick it in place.



### Warning

Before and during assembly, ensure that no persons are endangered by the material removed towards the outside. Carry out the last part of the installation with the utmost care and with little pressure so that the exterior plaster is not damaged.

2. Drill the hole for the condensate discharge line using the 20 mm masonry drill bit. Make sure that the bore runs downwards at an angle of at least 5° so that the condensate water can drain off easily.
3. Drill the holes for the exhaust air and fresh air supply using the 180 mm core drill bit.

### Notice

After drilling the two holes, make sure that the intake of the outside air and the return of the air to the outside are not obstructed by leafy plants, facade cladding, window shutters or similar. Remove the obstacles.

4. Use the template to mark the positions of the screws for the upper suspension rail and the position of the lower fixing screw for the mounting bracket.



5. Drill the holes with the 8 mm masonry drill bit so that they are suitable for the wall plugs supplied.

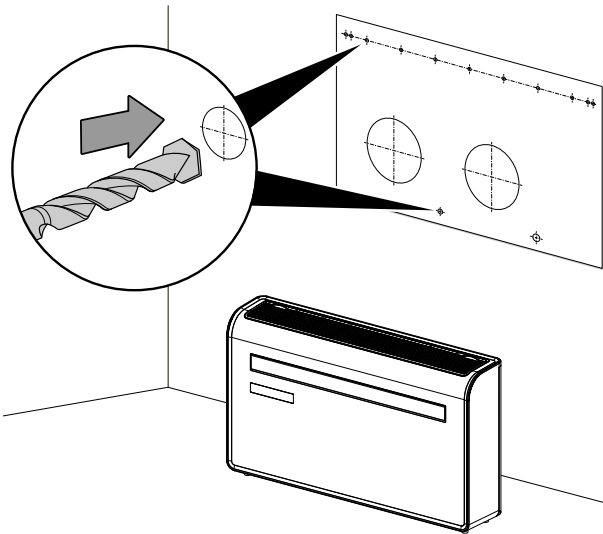

6. Mount the support rail to the wall and align it with the spirit level.

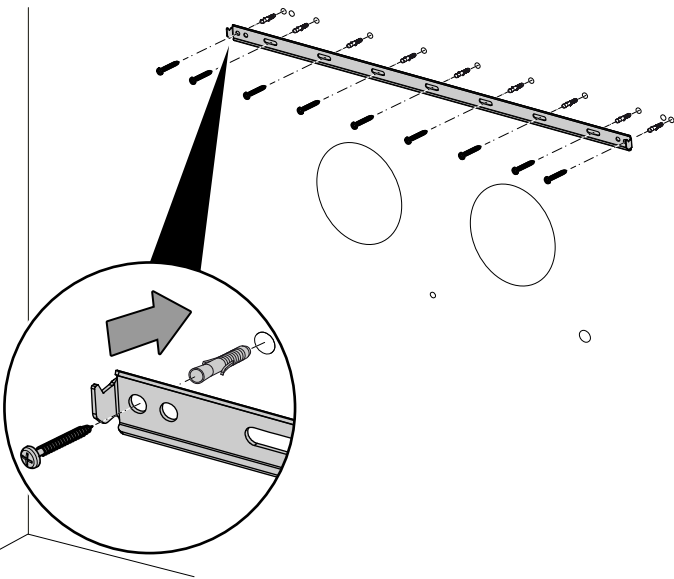

7. Check the attachment of the suspension rail and make sure that there is no risk of the device falling down.
8. Roll the plastic film sheets into a tube and feed them through the large wall holes until they are positioned flush with the interior wall.

9. Neatly cut off any excess plastic film sheets on the outer wall with a sharp knife.
- ⇒ The used tube should be approx. 240 mm long.

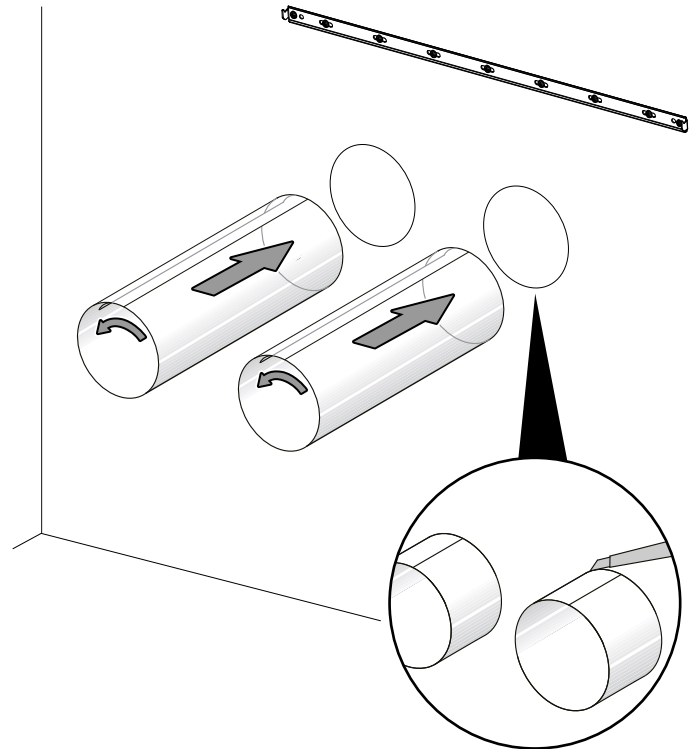

10. Place the hose adapters (interior; inner fixing ring) on the inside of the ventilation opening.
11. Then fold the hose adapters (exterior; outer ventilation cover) in half.
12. Attach the chains to each side of the ventilation cover before pushing the cover through the vent hole towards the outside.

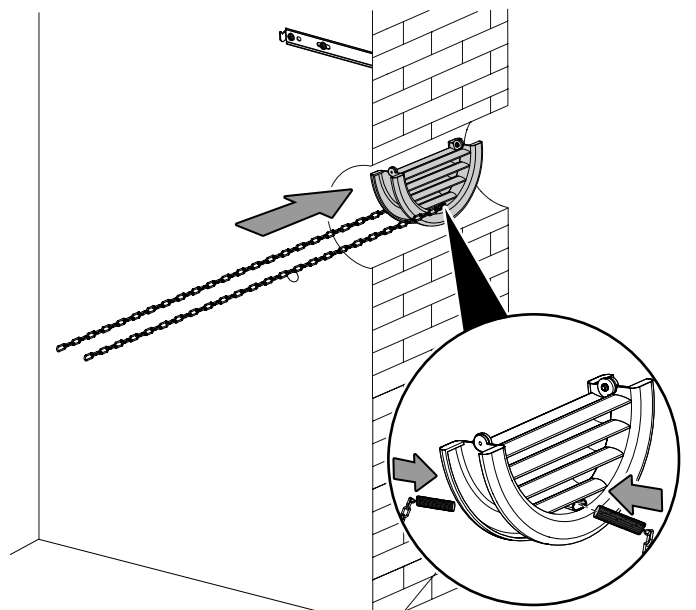

13. Fold out the outer cover before fixing the chains by hooking them into the inner fixing ring. This will firmly hold the external cover in position.

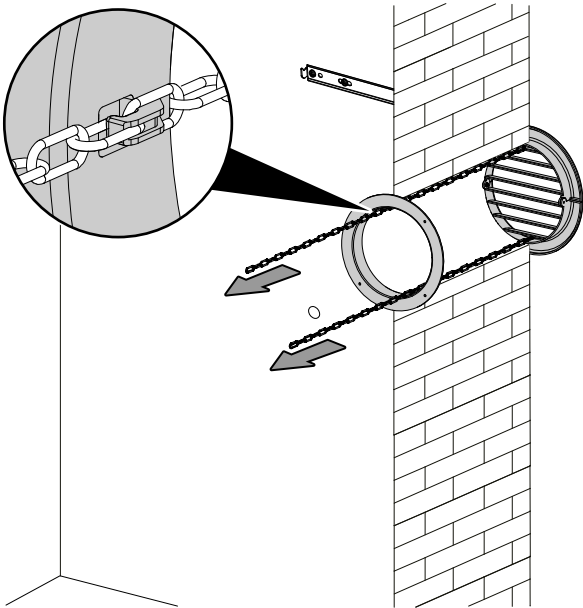

14. Secure the chains and cut off excess chain links.  
15. Attach the mounting bracket to the bottom edge of the device using the screws provided.  
16. Lift the device onto the wall, align the holes where the device is to be mounted with the hooks on the suspension rail and carefully place the device in position. At the same time, push the exhaust air pipe through the exhaust air hole.

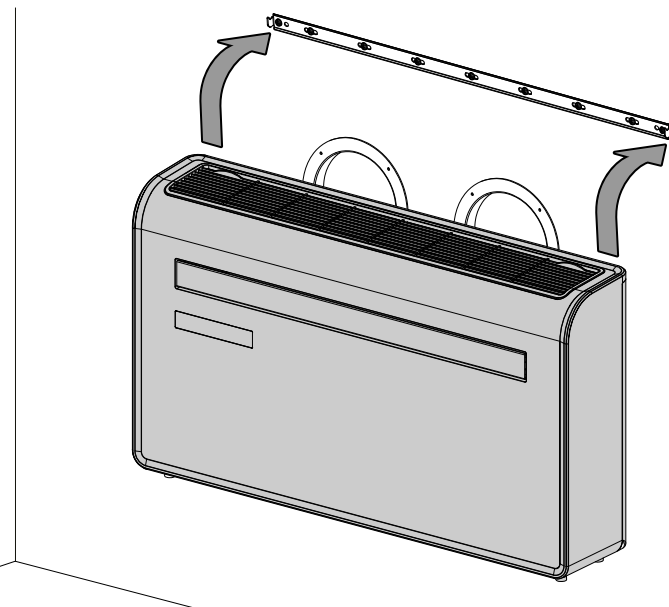

17. Pull the device onto the wall using the mounting bracket and a screw on the bottom edge.

#### Connecting the power cable

- Connect the mains plug to a properly secured socket.

## Operation

### Control panel

- Avoid open doors and windows.

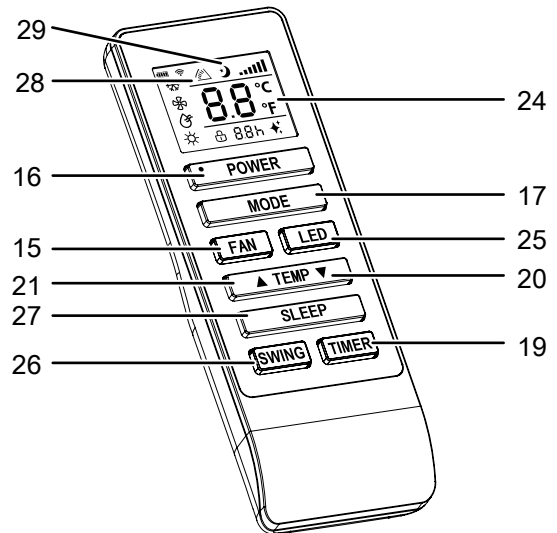
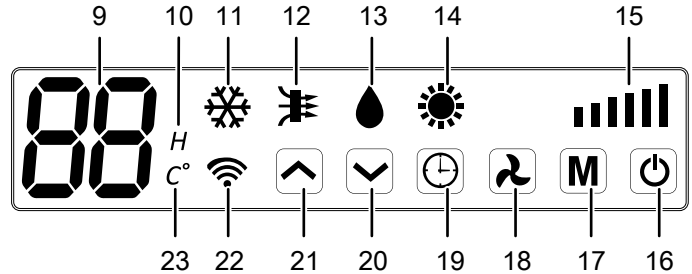

No.	Designation	Meaning
9	Segment display	Indication of the current room temperature Indication of the target temperature Indication of the set number of hours during timer programming Indication of the error code, see chapter Errors and faults
10	H LED	Indicates that the timer has been set
11	Cooling LED	Illuminated when <i>cooling</i> mode is activated
12	Ventilation LED	Illuminated when <i>ventilation</i> mode is activated
13	Dehumidification LED	Illuminated when <i>dehumidification</i> mode is activated
14	Heating LED	Illuminated when <i>heating</i> mode is activated; Flashes temporarily for as long as cold air protection is required
15	Fan speed LEDs	Fan speed indication

No.	Designation	Meaning
16	<i>On/Off</i> button	Switching the device on or off
17	<i>Mode</i> button	For selecting the operating mode: <i>Cooling</i> <i>Fan only</i> <i>Dehumidification</i> <i>Heating</i>
18	<i>Fan speed</i> button	Setting the fan speed
19	<i>Timer</i> button	<i>Automatic switch-on</i> timer function in increments of 1 hour (1 hour to 24 hours) <i>Automatic switch-off</i> timer function in increments of 1 hour (1 hour to 24 hours)
20	<i>Decrease value</i> button	Reducing the target temperature (16 °C to 30 °C) for cooling or heating For reducing the number of hours when programming the timer
21	<i>Increase value</i> button	Increasing the target temperature (16 °C to 30 °C) for cooling or heating For increasing the number of hours when programming the timer
22	<i>WiFi</i> LED	Illuminated when Wi-Fi is activated
23	<i>Temperature unit</i> LED	Indicates the currently set temperature unit (degrees Celsius or Fahrenheit)
24	Display	Indication of different device functions
25	<i>LED</i> button	For switching the LEDs on the control panel on or off
26	<i>Swing</i> button (remote control only)	For switching the swing function on or off
27	<i>Sleep</i> button (remote control only)	For switching night mode on or off
28	<i>Swing</i> LED (remote control only)	Illuminated when the swing function is activated
29	<i>Sleep</i> LED (remote control only)	Illuminated when night mode is activated



### Warning of electrical voltage

Risk of electric shock!

The device is not protected against water.

There is a risk of electric shock!

Never use the device in areas where dripping, spraying or running water can enter the device! Never immerse the device in water!

### Switching the device on

1. Once you have completely installed the device as described in the Start-up chapter, you can switch it on.
2. Press the *On/Off* button (16).
  - ⇒ The device starts in cooling mode.
  - ⇒ The *Cooling* LED (11) is illuminated.
  - ⇒ The *Fan speed* LED (15) is illuminated.
  - ⇒ The air outlet (5) opens automatically.
3. Select the desired operating mode.

### Setting the operating mode

- Cooling
- Fan only
- Dehumidification
- Heating

### Cooling

In *Cooling* mode the room will be cooled down to the desired target temperature.

1. Press the *Mode* button (17) until the *Cooling* LED (11) is illuminated.
2. Press the *Decrease value* button (20) or *Increase value* button (21) or to select the desired target temperature. The temperature can be adjusted in increments of 1 °C in a range between 16 °C and 30 °C.
  - ⇒ The desired target temperature is indicated on the segment display (9).
3. Press the *Fan speed* button (18) to set the desired fan stage.
  - ⇒ The *Fan speed* LED (15) for the desired fan stage will be illuminated.
  - ⇒ The *Cooling* LED (11) will be illuminated to indicate *cooling* mode.

### Fan only

In *Ventilation* mode the room air is circulated, it will neither be cooled nor dehumidified.

1. Press the *Mode* button (17) until the LED for *Ventilation* (12) lights up.
2. Press the *Fan speed* button (18) to set the desired fan speed.
  - ⇒ The LED for the selected fan speed (15) will be illuminated.

### Dehumidification

In *Dehumidification* mode the humidity level in the room is reduced.

The temperature cannot be adjusted and the fan runs at the lowest speed level.

1. Press the *Mode* button (17) until the *Dehumidification* LED (13) is illuminated.
  - ⇒ *Dehumidification* mode is selected.
  - ⇒ The temperature and the fan speed (stage 1) are preset in this operating mode and cannot be changed.
  - ⇒ The current room temperature is indicated on the segment display (9).

## Heating



### Warning of hot surface

In heating mode, the ventilation flap at the air outlet may become very hot and cause burns. Do not touch the ventilation flap during and after heating operation. Risk of burns.

In *Heating* mode the room will be heated up to the desired target temperature.

1. Press the *Mode* button (17) until the *Heating* LED (14) is illuminated.
  - ⇒ *Heating* mode is selected.
2. Repeatedly press the *Increase value* (20) or *Decrease value* button (21) to select the desired target temperature. The temperature can be adjusted in increments of 1 °C in a range between 16 °C and 30 °C.
  - ⇒ The desired target temperature is indicated on the segment display (9).

## Night mode

Night mode can be activated in *Cooling* and *Heating* mode.

The following settings are part of the night mode's *Cooling* mode:

- After 1 hour the preset temperature is increased by 1 °C. After another hour the preset temperature will again be increased by 1 °C.
- Temperature and fan speed cannot be changed in night mode.

The following settings are part of the night mode's *Heating* mode:

- After 1 hour the preset temperature is decreased by 1 °C. After another hour the preset temperature will again be decreased by 1 °C.
- Temperature and fan speed cannot be changed in night mode.

To activate night mode, please proceed as follows:

1. Select *Cooling* or *Heating* mode.
2. Press the *Sleep* button (27) on the remote control.
  - ⇒ The *Cooling* LED (11) or *Heating* LED (14) and the *Sleep* LED (29) are illuminated.
  - ⇒ The segment display (9) on the device will show the letters *SL*.
3. In order to switch off night mode, press the *Sleep* button (27) once again.
  - ⇒ The *Sleep* LED (29) on the remote control turns off.
  - ⇒ The selected operating mode remains active.

## Setting the timer

The timer function switches the device off after the set time has elapsed.

The number of hours of the timer can range from 1 to 24. The timer can be set in increments of 1 hour.

The function can be set in all operating modes. It can be activated both during operation and in standby mode.

*Automatic switch-on* and *Automatic switch-off* can be enabled at the same time with the Trotec Assistant App.

- ✓ **Automatic switch-on:** The device is now in standby mode.
- ✓ **Automatic switch-off:** The device is switched on.
  1. Press the *Timer* button (19) to activate the timer.
  2. Press the *Decrease value* (20) or *Increase value* button (21) to select the desired number of hours until automatic switch-on or switch-off.
  3. Wait for approx. 3 seconds to confirm the setting.
    - ⇒ The segment display (9) continuously indicates the number of hours until automatic switch-on or switch-off.
    - ⇒ The *H* LED (10) is illuminated on the control panel.
    - ⇒ After the predefined time, the device switches itself on or off.
    - ⇒ If the device is disconnected from the power supply, all settings for automatic switch-on/switch-off are deleted.
    - ⇒ Manually switching the device off disables the automatic switch-off function.
    - ⇒ Manually switching the device on disables the automatic switch-on function.
    - ⇒ If you select **0** hours, the timer switches off.

## Swing function

The swing function can be switched on in any operating mode if required.

By means of the swing function, the air outlet (5) is moved automatically and thus ensures continuous air circulation.

1. Press the *Swing* button (26) on the remote control.
  - ⇒ The ventilation flap moves up and down continuously.
  - ⇒ The *Swing* LED (28) is illuminated.
2. Press the *Swing* button (26) again to stop the ventilation flap in a certain position and to switch off the swing function.
  - ⇒ The *Swing* LED (28) on the remote control turns off.

## Memory function

After a power failure during operation the device will automatically be switched back on. The chosen operating mode settings will be saved, a possibly programmed timer will not.

The compressor may start up with a delay of 3 minutes, as it is provided with an internal protection against direct restart.

## Trotec Assistant App



All settings can also be made via the Trotec Assistant App. The settings of the timer functions that are operated via the app are not additionally displayed on the control panel of the device.

Install the Trotec Assistant App on the terminal device you want to use in combination with the device.



### Info

Some of the app's functions require access to your location and an active Internet connection.

The app is available for download in the Google Play Store as well as in Apple's app store and via the following link:



<https://hub.trotec.com/?id=45093>

## WiFi connection

Proceed as follows to establish a WiFi connection:

- ✓ The device is now in standby mode.
- 1. Download the Trotec Assistant App and open it on a smartphone.
- 2. Select *Add Device* by pressing the + symbol in the top right corner.
- 3. Select *Large household appliances* and *Air conditioning (Wi-Fi)* among them.
- 4. Press the *fan speed* button (18) on the control panel of the device for approx. 3 seconds.
  - ⇒ The *WiFi* LED (22) lights up.
- 5. Press the *fan speed* button (18) again on the control panel of the device for approx. 3 seconds.
  - ⇒ The *WiFi* LED (22) flashes approx. twice per second.
  - ⇒ The device is in *Quick Connect* mode.
- 6. Follow the instructions of the app on the smartphone.
  - ⇒ Once the *WiFi* LED (22) is permanently illuminated, the connection is established.



### Info

If the WiFi connection is interrupted, the device may not automatically reconnect to the network. If this is the case, re-establish the connection with the *fan speed* button (18).

## Shutdown



### Warning of electrical voltage

Do not touch the mains plug with wet or damp hands.

- Press the *On/Off* button (16) to switch the device off.
- Switch off the device.
- Disconnect the device from the mains by removing the mains plug from the socket. When doing so, be sure to hold the plug, not the cable.
- If required, clean the device according to the "Maintenance" chapter.

## Errors and faults

The device has been checked for proper functioning several times during production. If malfunctions occur nonetheless, check the device according to the following list.

### Notice

Wait for at least 3 minutes after maintenance and repair work. Only then switch the device back on.

### The device does not start:

- Check the power connection.
- Check the power cable and mains plug for damage. If you notice damages, do not try to take the device back into operation. If the supply cord is damaged, it must be replaced by the manufacturer, its service agent or similarly qualified persons in order to avoid a hazard.
- Check the on-site fusing.
- Observe the operating temperature according to the chapter Technical annex.
- If the device is not starting, have the electrics checked by a specialist company or by the manufacturer.

### The device works with reduced or no cooling capacity:

- Check whether *cooling* mode is selected.
- Check the position of the ventilation flaps. They should be opened to the maximum.
- Check the air filter(s) for dirt. If necessary, clean or replace the air filter(s).
- Check whether there are opened windows and/or doors of the room. If so, close them.
- Check the temperature setting at the device. Reduce the set temperature if it is higher than the room temperature.

### Condensate is leaking:

- Check the device for leaks.



### The compressor does not start:

- Check whether the overheating protection of the compressor has tripped. Disconnect the device from the mains and let it cool down for approx. 10 minutes before reconnecting it.
- Check whether the ambient temperature equals the target temperature (in *cooling* mode). The compressor only switches on if the ambient temperature is higher than the target temperature.
- The compressor may start up with a delay of 3 minutes, as it is provided with an internal protection against direct restart.

### The device gets very warm, is loud or is losing power:

- Check the air inlet and air filter for dirt. Remove external dirt.
- From the outside, check the device for dirt (see chapter Maintenance). If the inside of the device is dirty, have it cleaned by a specialist company for cooling and air-conditioning or by the manufacturer.

### The device does not respond to the infrared remote control:

- Check whether the distance between remote control and device is too large and reduce it if necessary.
- Make sure there are no obstacles, such as furniture or walls, between the device and the remote control. Ensure visual contact between device and remote control.
- Check the charging status of the batteries and change them if required.
- If the batteries have just been changed, check them for correct polarity.

### The device still does not operate correctly after these checks:

Please contact the customer service. If necessary, bring the device to a specialist company for cooling and air-conditioning or to the manufacturer for repair.

### Error codes

The following error messages can be displayed on the segment display (9). Contact the manufacturer and state the error message.

Error code	Cause
F1	Compressor drive failure
F2	PFC/IPM error
F3	Start error of compressor
F4	Compressor drive failure
F5	Location detection loop error
FA	Phase current overcurrent protection
P2	DC bus voltage undervoltage protection
E4	Communication error (indoor and outdoor)
F6	PCB communication error
P3	AC Input voltage protection
P4	AC overcurrent protection
P5	AC undervoltage protection
F7	Coil sensor error (outdoor)
F8	Sensor on suction pipe error
E0	Sensor on discharge pipe error
E6	Temperature sensor error (outdoor)
E7	Fan motor error (outdoor)
FE	Software error of the mainboard
PA	Error with return air temperature sensor
P1	Overheating protection at the top of compressor
PE	Abnormal refrigerant circulation
PH	Fault in refrigerant circuit
PC	Exhaust temperature protection
E3	DC fan feedback failure (indoor)
P6	Coil tube overload protection (indoor)
P7	Defrost protection on coil tube (indoor)
E2	Sensor error on indoor coil tube
E1	Temperature sensor error (indoor)
P8	Zero-crossing fault detection (indoor)
EE	Software error of the mainboard
E5	Water-splash motor error
E8	Fan feedback fault
FL	Water-full protection



## Maintenance

## Maintenance intervals

Maintenance and care interval	before every start-up	as needed	at least every 2 weeks	at least every 4 weeks	at least every 6 months	at least annually
Check air inlets and outlets for dirt and foreign objects and clean if necessary	X			X		
Clean the exterior		X				X
Visually check the inside of the device for dirt		X				X
Check the air filter for dirt and foreign objects and clean or replace if necessary	X		X			
Check for damage	X					
Check the attachment screws		X				X
Test run						X
Empty the condensation tray and drain hose		X				

## Maintenance and care log

Device type: .....

Device number: .....

Maintenance and care interval	1	2	3	4	5	6	7	8	9	10	11	12	13	14	15	16
Check air inlets and outlets for dirt and foreign objects and clean if necessary																
Clean the exterior																
Visually check the inside of the device for dirt																
Check the air filter for dirt and foreign objects and clean or replace if necessary																
Check for damage																
Check the attachment screws																
Test run																
Empty the condensation tray and drain hose																
Comments																

1. Date: ..... Signature: .....	2. Date: ..... Signature: .....	3. Date: ..... Signature: .....	4. Date: ..... Signature: .....
5. Date: ..... Signature: .....	6. Date: ..... Signature: .....	7. Date: ..... Signature: .....	8. Date: ..... Signature: .....
9. Date: ..... Signature: .....	10. Date: ..... Signature: .....	11. Date: ..... Signature: .....	12. Date: ..... Signature: .....
13. Date: ..... Signature: .....	14. Date: ..... Signature: .....	15. Date: ..... Signature: .....	16. Date: ..... Signature: .....

## Activities required before starting maintenance



### Warning of electrical voltage

Do not touch the mains plug with wet or damp hands.

- Press the *On/Off* button (16) to switch the device off.
- Disconnect the device from the mains by removing the mains plug from the socket. When doing so, be sure to hold the plug, not the cable.



### Warning of electrical voltage

Tasks which require the device to be opened must only be carried out by authorised specialist companies or by the manufacturer.

## Refrigerant circuit



### Danger

#### Natural refrigerant propane (R290)!

H220 – Extremely flammable gas.

H280 – Contains gas under pressure; may explode if heated.

P210 – Keep away from heat, sparks, open flames and other ignition sources. No smoking.

P377 – Leaking gas fire: Do not extinguish, unless leak can be stopped safely.

P410+P403 – Protect from sunlight. Store in a well-ventilated place.

- The entire refrigerant circuit is a maintenance-free, hermetically sealed system and may only be maintained or repaired by specialist companies for cooling and air-conditioning or by the manufacturer.

## Safety signs and labels on the device

Check the safety signs and labels attached to the device at regular intervals. Replace illegible safety signs!

## Cleaning the housing

Clean the housing with a soft, damp and lint-free cloth. Make sure that no moisture enters the housing. Protect electrical components from moisture. Do not use any aggressive cleaning agents such as cleaning sprays, solvents, alcohol-based or abrasive cleaners to dampen the cloth.

## Visual inspection of the inside of the device for dirt

1. Remove the air filter.
2. Use a torch to illuminate the openings of the device.
3. Check the inside of the device for dirt.
4. If you see a thick layer of dust, have the inside of the device cleaned by a specialist company for cooling and air-conditioning or by the manufacturer.
5. Put the air filter back in.

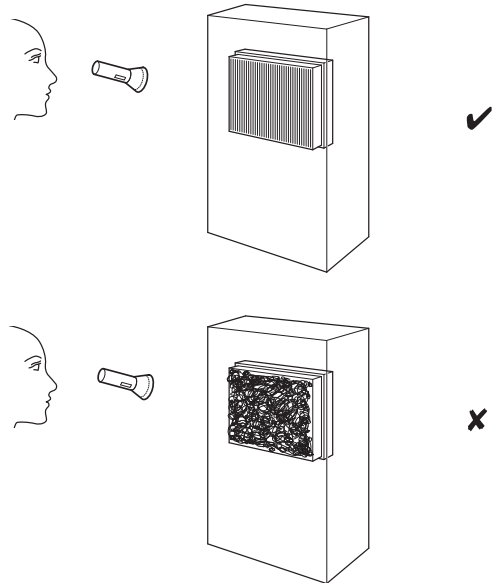

## Cleaning the air filter

The air filter has to be cleaned as soon as it is dirty. This is brought to light e.g. by a reduced capacity (see chapter Errors and faults).



### Warning

Ensure that the air filter is not worn or damaged. The corners and edges of the air filter must not be deformed or rounded. Before reinserting the air filter, make sure that it is undamaged and dry!

1. Remove the air filter from the device.

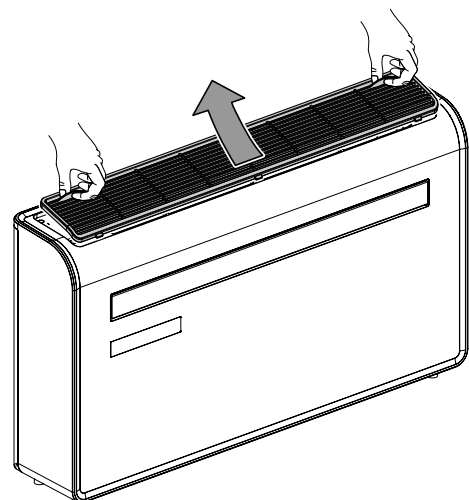

2. Clean the filter using a slightly damp, soft, lint-free cloth. If the air filter is heavily contaminated, clean it with warm water mixed with a neutral cleaning agent.
3. Allow the filter to dry completely. Do not insert a wet filter into the device!
4. Reinsert the air filter into the device.

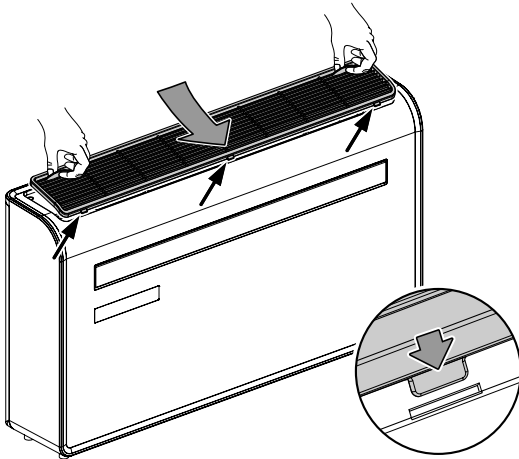

### Activities required after maintenance

If you want to continue using the device:

- Leave the device to rest for at least 12 hours, so the refrigerant can accumulate within the compressor. Wait 12 hours before switching the device back on! Acting contrary might lead to compressor damage and a malfunctioning device.
- Reconnect the device to the mains.

If you do not intend to use the device for a considerable time:

- Store the device according to the Transport and storage chapter.

## Technical annex

### Technical data

Model	PAC-W 2650 SH
Cooling capacity	2.65 kW
Heating capacity	2.3 kW
Dehumidification performance	1.2 l/h
Operating temperature	7 °C to 35 °C
Temperature setting range	16 °C to 30 °C
Max. air volume flow	500 m³/h
Mains connection	220 V – 240 V / 50 Hz
Nominal current	5 A
Type of protection	IPX0
Power input (cooling operation)	1 kW
Power input (heating operation)	0.7 kW
Sound pressure level at a distance of 1 m	48 dB(A)
Refrigerant	R290
Amount of refrigerant	290 g
GWP factor	3
CO <sub>2</sub> equivalent	0.00087 t
Suction side pressure	1.3 MPa
Discharge side pressure	3.8 MPa
Max. permissible pressure	3.8 MPa
Dimensions (length x width x height)	1000 x 205 x 585 mm
Minimum distance to walls and other objects:	top: 20 cm sides: 10 cm front: 10 cm
Weight	40 kg
Remote control battery	Type LR03 / AAA – 1.5 V
Wifi frequency band	2.4 GHz

## Circuit diagram

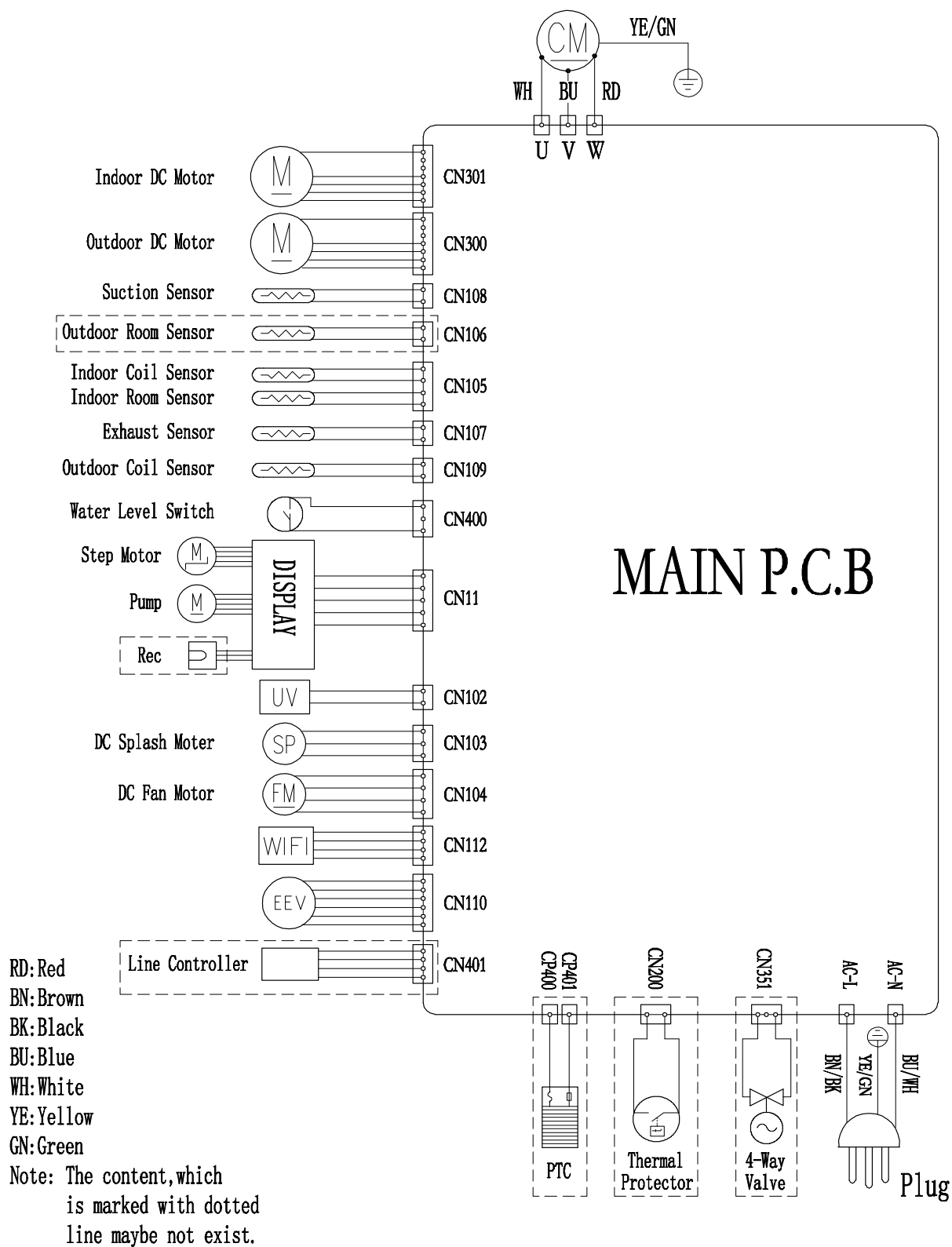

## Overview and list of spare parts

**Note:** The position numbers of the spare parts differ from those describing the positions of other parts mentioned in this operating manual.

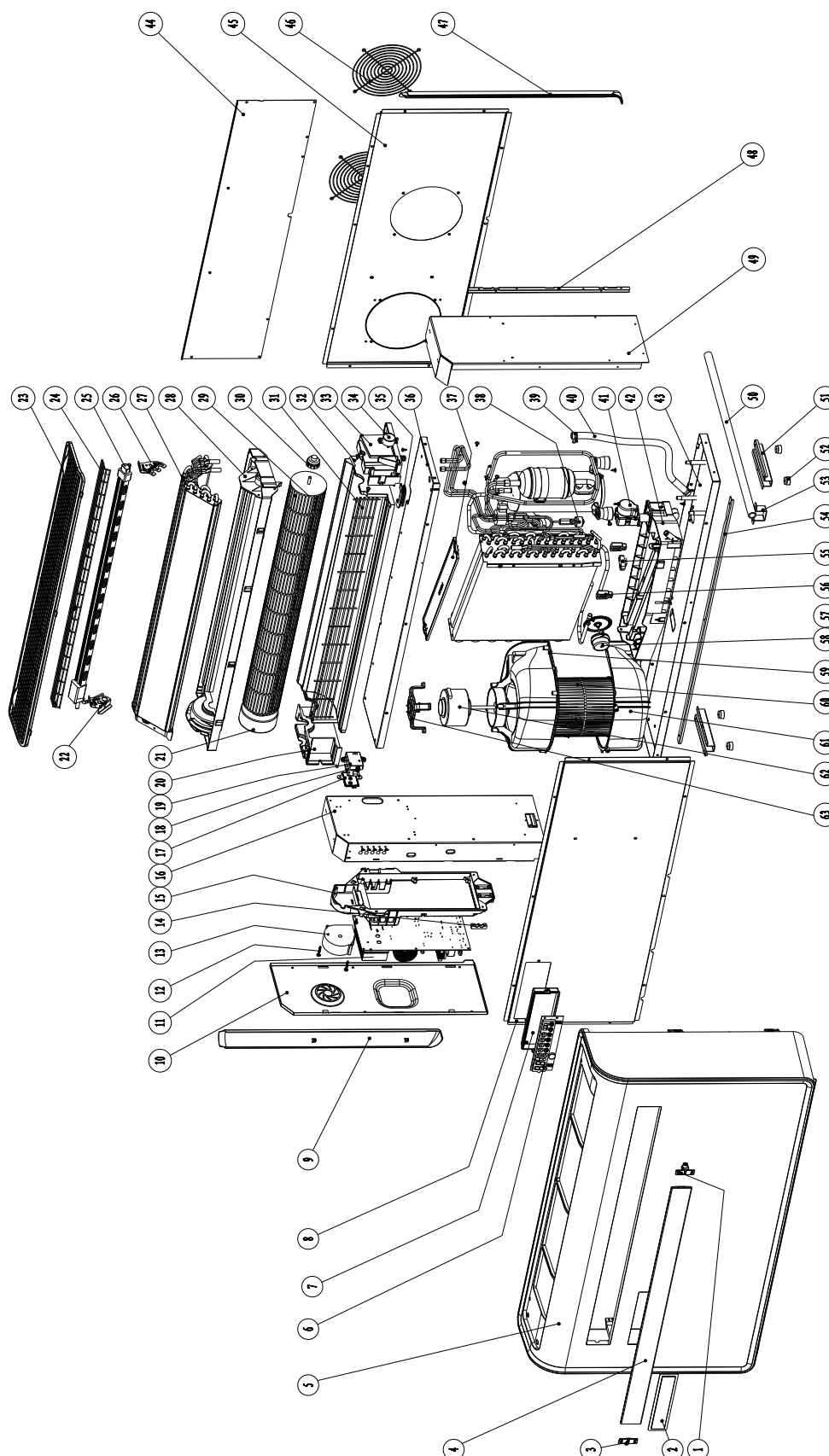

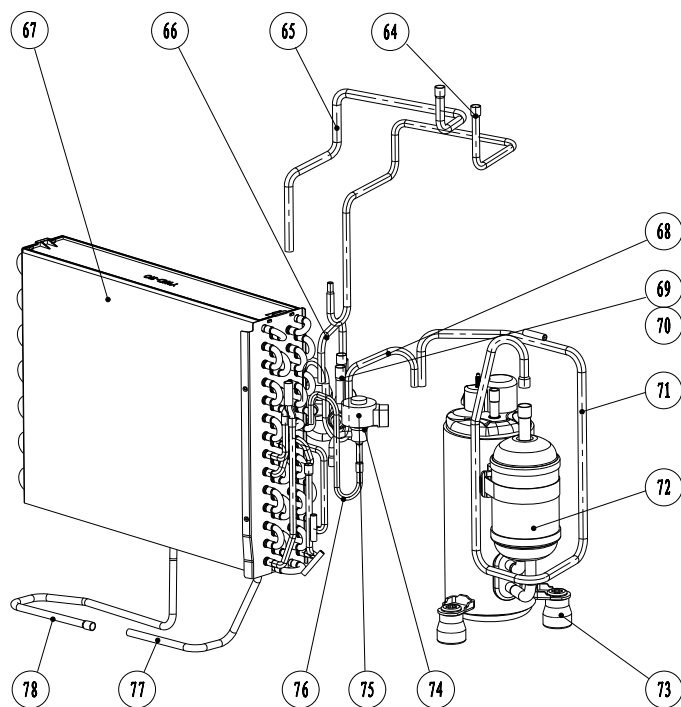

No.	Spare part	No.	Spare part	No.	Spare part
1	Guide vane right fixed cart	27	Evaporator assembly	53	Water management card
2	Transparent mirror	28	Water pans	54	Front panel tabs
3	Air deflector fixing part	29	Air supply wind turbines	55	Rubber support block 2
4	Air deflector	30	Rotor shaft sleeve	56	Rubber support block 1
5	The front panel	31	Outlet guard	57	Water wheel
6	Display light panel	32	Air duct foam	58	Dc water drawing motor
7	Display panel mounting box	33	The right base	59	Lower air duct 1
8	Front cover	34	Stepper motor	60	Exhaust wind turbines
9	Left trim strip	35	Middle partition seal rubber	61	Lower air duct 2
10	Electronical control box cover	36	The partition	62	Plastic sealed dc brushless motor
11	Driver board	37	Condenser cover	63	The motor bracket
12	Screw	38	Water level switch	64	Electronic expansion valve nozzles 1
13	Cooling fan	39	Torsion spring	65	Four way valve connection 2
14	Line pressing board	40	Water pipe	66	Four way valve connection 1
15	Plastic electric control box	41	Water release switch assembly	67	Condenser assembly
16	The left support plate	42	Under water pans	68	Compressor discharge pipe
17	WIFI protection box cover	43	Chassis	69	Four way valve
18	WIFI module	44	The after cover plate	70	Four way valve coil
19	WIFI protective box	45	Back panel	71	Compressor suction pipe
20	Left base	46	Rear protection filter	72	The compressor
21	Plastic sealed dc brushless motor	47	Right trim strip	73	Compressor footing
22	Left fixing plate	48	Right link bar	74	Electronic expansion valve coil
23	Filter	49	Light support plate	75	Electronic expansion valve
24	Protectin filter	50	Drain pipe	76	Electronic expansion valve nozzles 2
25	PTC heater	51	Chassis stents	77	Heating tube 1
26	Right fixing tube	52	The rubber feet	78	Heating tube 2



## Disposal

Always dispose of packing materials in an environmentally friendly manner and in accordance with the applicable local disposal regulations.

You are responsible for deleting personal data from the device that is to be disposed of.



The icon with the crossed-out wheeled bin indicates that this device and any associated components (e.g. remote controls) must not be disposed of with household waste at the end of their life, in accordance with the Waste Electrical and Electronic Equipment Directive (2012/19/EU) and national laws.

You will find collection points for free return of waste electrical and electronic equipment in your vicinity. The addresses can be obtained from your municipality or local administration. You can also find out about other return options that apply for many EU countries on the website <https://hub.trotec.com/?id=45090>. Otherwise, please contact an official recycling centre for electronic and electrical equipment authorised for your country.

The separate collection of waste electrical and electronic equipment aims to enable the re-use, recycling and other forms of recovery of waste equipment as well as to prevent negative effects for the environment and human health caused by the disposal of hazardous substances potentially contained in the equipment.



This icon with the crossed-out wheeled bin indicates that batteries or accumulators must not be disposed of with household waste at the end of their life. If the device contains batteries or accumulators that contain mercury, cadmium or lead, the respective chemical symbol (Hg, Cd or Pb) is shown below the icon of the crossed-out wheeled bin. To prevent environmental pollution, do not carelessly leave batteries or electrical and electronic equipment containing batteries in public areas. In the European Union, batteries and accumulators must be returned to a designated collection point in accordance with REGULATION (EU) 2023/1542 OF THE EUROPEAN PARLIAMENT AND OF THE COUNCIL of 12 July 2023 concerning batteries and waste batteries. Remove batteries/accumulators and dispose of them separately according to the relevant legal requirements.

Have the refrigerant (propane) disposed of appropriately and according to the national regulations by a company with the relevant certification (European Waste Catalogue 160504).

## Only for United Kingdom

According to Waste Electrical and Electronic Equipment Regulations 2013 (SI 2013/3113) (as amended) and the Waste Batteries and Accumulators Regulations 2009 (SI 2009/890) (as amended), devices that are no longer usable must be collected separately and disposed of in an environmentally friendly manner.

## Simplified EU Declaration of Conformity

Hereby, Trotec GmbH declares that the radio equipment type (PAC-W 2650 SH – Wifi module) is in compliance with Directive 2014/53/EU. The full text of the EU declaration of conformity is available at the following internet address:  
<https://hub.trotec.com/?id=46475>

Trotec GmbH

Grebbeener Str. 7  
52525 Heinsberg  
Germany

☎ +49 2452 962-0

☎ +49 2452 962-200

[online@trotec.com](mailto:online@trotec.com)

[www.trotec.com](http://www.trotec.com)